

2P

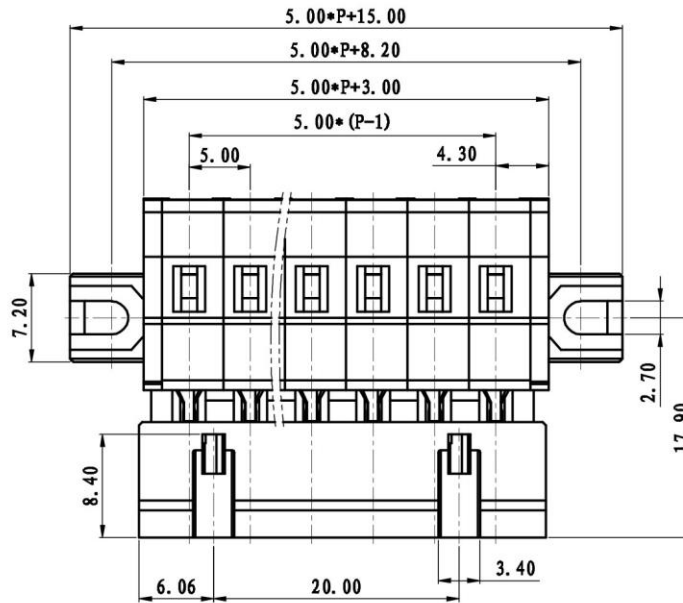
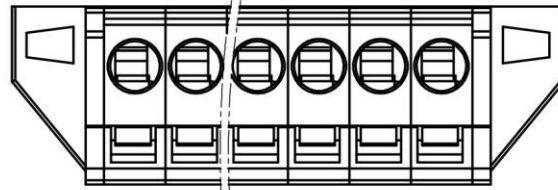
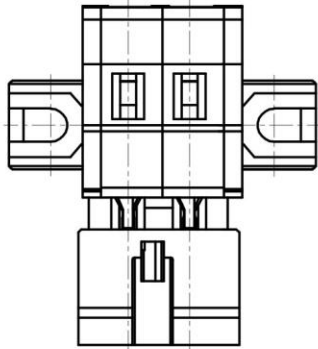

REVISION RECORD			
REV.	CONTENT	MOD.	DATE
①	初版发行		

NOTES:
 Pitch : 5.0mm
 Rated Voltage : 300 V
 Rated Current : 15 A
 Withstand Voltage :
 AC2500V for 1 minute
 Insulation Resistance :
 500MΩ / DC500V
 Using Temperature Range :
 -40℃ ~ +105℃
 Wire range : 22~ 14AWG

技术要求:
 间距: 5.0mm
 额定电压: 300V
 额定电流: 15A
 耐电压值: AC2500V/min
 绝缘阻抗: 500MΩ/DC500V
 使用条件: -40℃~+105℃
 适用线规: 22~ 14AWG

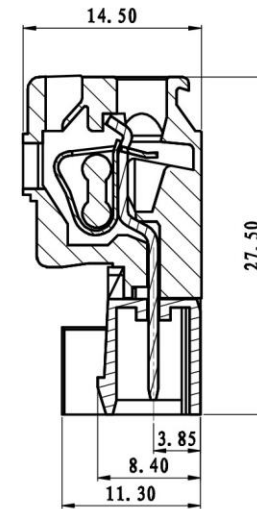

3P

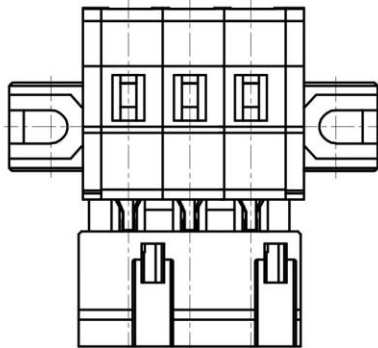

	pitch dimension			Nominal dimension					— /
	over	over	over	over	over	over	over	over	
variable	0	6	10	0	30	60	100	150	/
range	to	to	to	to	to	to	to		
	6	10	24	30	60	100	150		⌒
Tolerance	±0.1	±0.15	±0.25	±0.2	±0.3	±0.5	±0.7	±1.0	0.05/10

6	LSC10-方针	1062B0001AV	P	黄铜	镀雾锡
5	LSC1-弹片	F2A0DLSLC1BV	P	不锈钢	
4	LSZ10B-5.0-主体	1088A0YXXAV	1	PA66	
3	LSC10M-5.08-盖板2	1064C0Y01AV	1	PA66	
2	LSC10M-5.08-盖板1	1063C0Y01AV	1	PA66	
1	LSC10-5.0-本体	1069A0Y01AV	P	PA66	

NO.	NAME OF PART	NO. OF PART	QTY	MATERIAL	NOTES
DES.	LDD	DATE	12/08/15	UNITS	mm
CHK.		DATE		SIZE	A4
APP.		DATE		SCALE	1:1
		DWG NO.	SP-2-1088003	REV:	V0

上海有乐电气有限公司
 Shanghai YouLe Electric CO.,LTD

TITLE

LSC10BM-5.0-XXP-1Y-00A
 LSC10BM-5.0-成品

REVISION RECORD			
REV.	CONTENT	MOD.	DATE
①	初版发行		

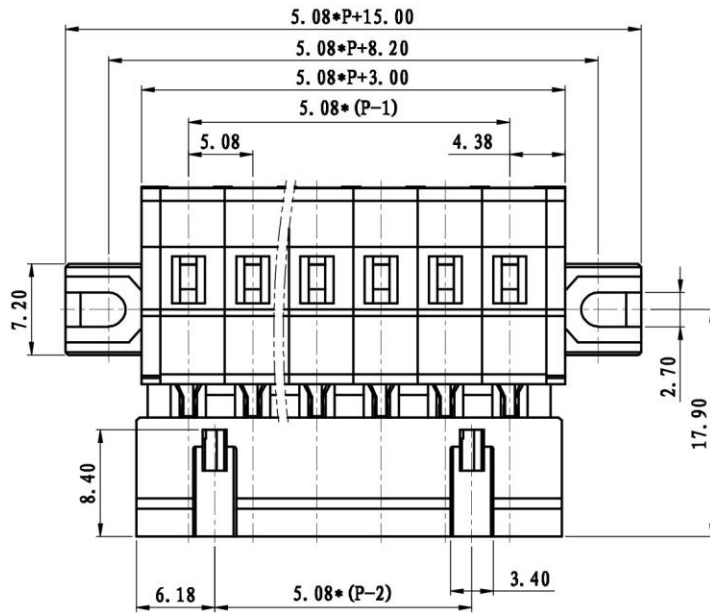
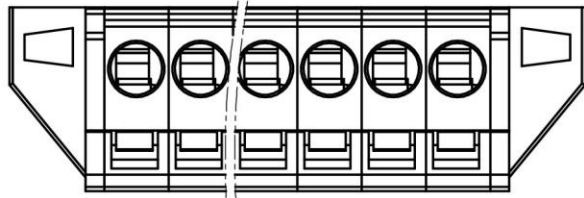

NOTES:

Pitch : 5.08mm
 Rated Voltage : 300 V
 Rated Current : 15 A
 Withstand Voltage :
 AC2500V for 1 minute
 Insulation Resistance :
 500MΩ / DC500V
 Using Temperature Range :
 -40℃ ~ +105℃
 Wire range : 22~ 14AWG

技术要求:

间距: 5.08mm
 额定电压: 300V
 额定电流: 15A
 耐电压值: AC2500V/min
 绝缘阻抗: 500MΩ/DC500V
 使用条件: -40℃~+105℃
 适用线规: 22~ 14AWG

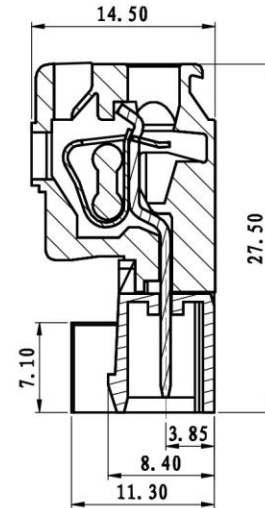

6	LSC10-方针	1062B0001AV	P	黄铜	镀雾锡
5	LSC1-弹片	F2A0DLSLC1BV	P	不锈钢	
4	LSZ10B-5.08-主体	1087A0YXXAV	1	PA66	
3	LSC10M-5.08-盖板2	1064C0Y01AV	1	PA66	
2	LSC10M-5.08-盖板1	1063C0Y01AV	1	PA66	
1	LSC10-5.08-本体	1062A0Y01AV	P	PA66	

NO.	NAME OF PART	NO. OF PART	QTY	MATERIAL	NOTES
DES.	LDD	DATE	12/08/15	UNITS	mm
CHK.		DATE		SIZE	A4
APP.		DATE		SCALE	1:1

上海有乐电气有限公司 Shanghai YouLe Electric CO.,LTD	TITLE	LSC10BM-5.08-XXP-1Y-00A
		LSC10BM-5.08-成品

	pitch dimension			Nominal dimension					— /
	over 0	over 6	over 10	over 0	over 30	over 60	over 100	over 150	
variable range	to 6	to 10	to 24	to 30	to 60	to 100	to 150		□ ○
Tolerance	±0.1	±0.15	±0.25	±0.2	±0.3	±0.5	±0.7	±1.0	0.05/10