

2P

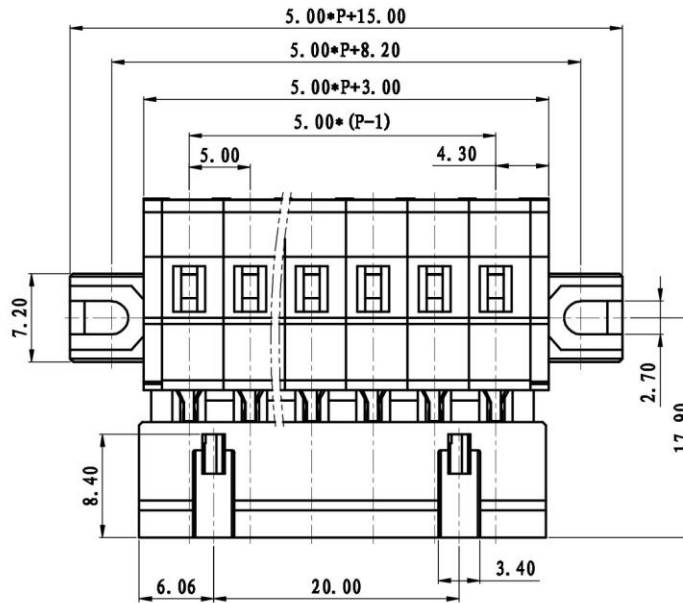
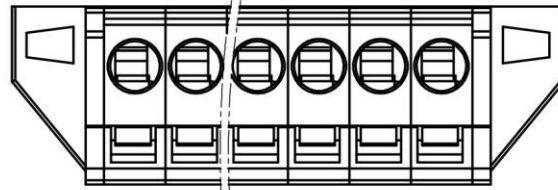
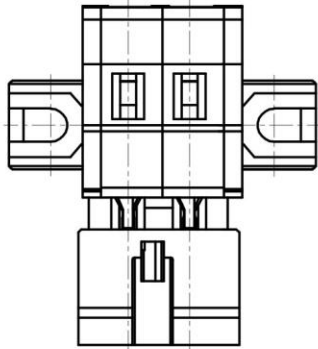

REVISION RECORD

| REV. | CONTENT | MOD. | DATE |
|------|---------|------|------|
| ①    | 初版发行    |      |      |

NOTES:  
 Pitch : 5.0mm  
 Rated Voltage : 300 V  
 Rated Current : 15 A  
 Withstand Voltage :  
 AC2500V for 1 minute  
 Insulation Resistance :  
 500MΩ / DC500V  
 Using Temperature Range :  
 -40℃ ~ +105℃  
 Wire range : 22~ 14AWG

技术要求:  
 间距: 5.0mm  
 额定电压: 300V  
 额定电流: 15A  
 耐电压值: AC2500V/min  
 绝缘阻抗: 500MΩ/DC500V  
 使用条件: -40℃~+105℃  
 适用线规: 22~ 14AWG

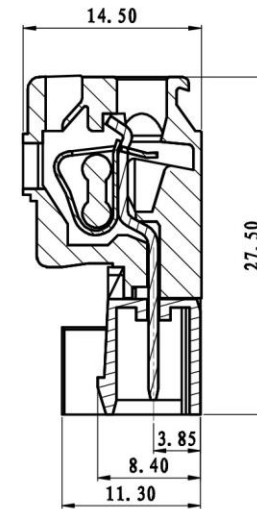

3P

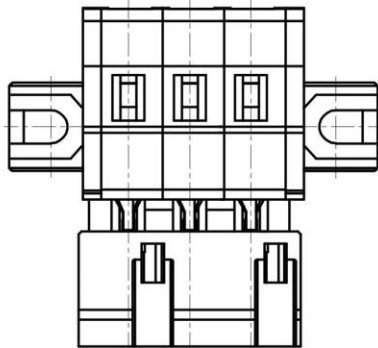

|   |                 |              |   |      |     |
|---|-----------------|--------------|---|------|-----|
| 6 | LSC10-方针        | 1062B0001AV  | P | 黄铜   | 镀雾锡 |
| 5 | LSC1-弹片         | F2A0DLSLC1BV | P | 不锈钢  |     |
| 4 | LSZ10B-5.0-主体   | 1088A0YXXAV  | 1 | PA66 |     |
| 3 | LSC10M-5.08-盖板2 | 1064C0Y01AV  | 1 | PA66 |     |
| 2 | LSC10M-5.08-盖板1 | 1063C0Y01AV  | 1 | PA66 |     |
| 1 | LSC10-5.0-本体    | 1069A0Y01AV  | P | PA66 |     |

| NO.  | NAME OF PART | NO. OF PART | QTY      | MATERIAL | NOTES |
|------|--------------|-------------|----------|----------|-------|
| DES. | LDD          | DATE        | 12/08/15 | UNITS    | mm    |
| CHK. |              | DATE        |          | SIZE     | A4    |
| APP. |              | DATE        |          | SCALE    | 1:1   |

|   |       |                        |
|---|-------|------------------------|
| 上海有乐电气有限公司<br>Shanghai YouLe Electric CO.,LTD | TITLE | LSC10BM-5.0-XXP-1Y-00A |
|   |       | LSC10BM-5.0-成品         |

|           | pitch dimension |       |       | Nominal dimension |      |      |      |      | —<br>◇<br>○ |
|-----------|-----------------|-------|-------|-------------------|------|------|------|------|-------------|
|           | over            | over  | over  | over              | over | over | over | over |             |
| variable  | 0               | 6     | 10    | 0                 | 30   | 60   | 100  | 150  | ◇<br>○      |
| range     | to              | to    | to    | to                | to   | to   | to   |      |             |
|           | 6               | 10    | 24    | 30                | 60   | 100  | 150  |      |             |
| Tolerance | ±0.1            | ±0.15 | ±0.25 | ±0.2              | ±0.3 | ±0.5 | ±0.7 | ±1.0 | 0.05/10     |

| REVISION RECORD |         |      |      |
|-----------------|---------|------|------|
| REV.            | CONTENT | MOD. | DATE |
| ①               | 初版发行    |      |      |

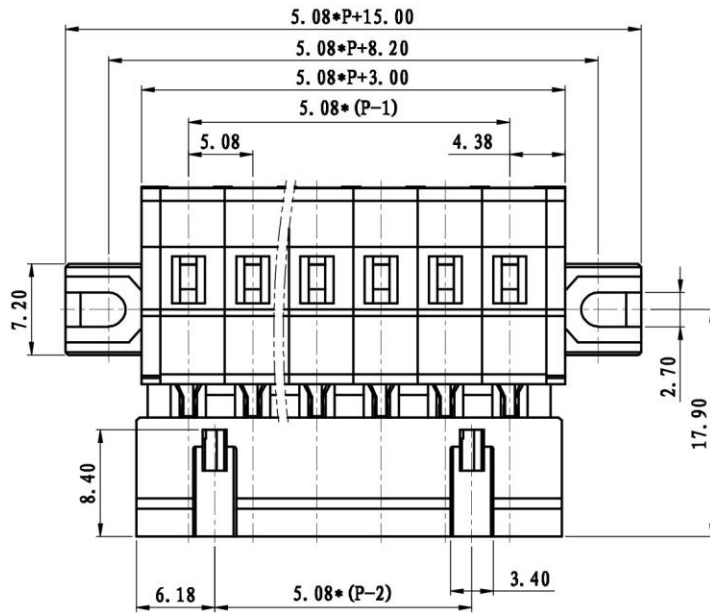
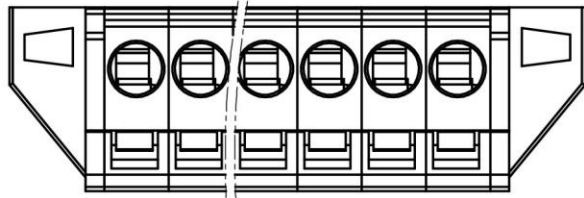

NOTES:

Pitch : 5.08mm  
 Rated Voltage : 300 V  
 Rated Current : 15 A  
 Withstand Voltage :  
 AC2500V for 1 minute  
 Insulation Resistance :  
 500MΩ / DC500V  
 Using Temperature Range :  
 -40℃ ~ +105℃  
 Wire range : 22~ 14AWG

技术要求:

间距: 5.08mm  
 额定电压: 300V  
 额定电流: 15A  
 耐电压值: AC2500V/min  
 绝缘阻抗: 500MΩ/DC500V  
 使用条件: -40℃~+105℃  
 适用线规: 22~ 14AWG

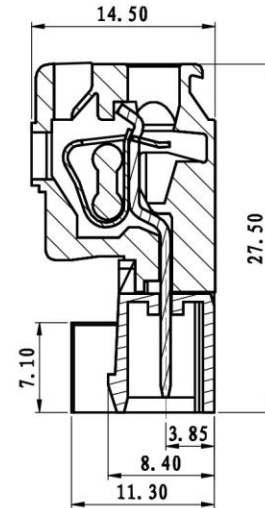

|   |                 |              |   |      |     |
|---|-----------------|--------------|---|------|-----|
| 6 | LSC10-方针        | 1062B0001AV  | P | 黄铜   | 镀雾锡 |
| 5 | LSC1-弹片         | F2A0DLSLC1BV | P | 不锈钢  |     |
| 4 | LSZ10B-5.08-主体  | 1087A0YXXAV  | 1 | PA66 |     |
| 3 | LSC10M-5.08-盖板2 | 1064C0Y01AV  | 1 | PA66 |     |
| 2 | LSC10M-5.08-盖板1 | 1063C0Y01AV  | 1 | PA66 |     |
| 1 | LSC10-5.08-本体   | 1062A0Y01AV  | P | PA66 |     |

| NO.  | NAME OF PART | NO. OF PART | QTY      | MATERIAL | NOTES |
|------|--------------|-------------|----------|----------|-------|
| DES. | LDD          | DATE        | 12/08/15 | UNITS    | mm    |
| CHK. |              | DATE        |          | SIZE     | A4    |
| APP. |              | DATE        |          | SCALE    | 1:1   |

|   |       |                         |
|---|-------|-------------------------|
| 上海有乐电气有限公司<br>Shanghai YouLe Electric CO.,LTD | TITLE | LSC10BM-5.08-XXP-1Y-00A |
|   |       | LSC10BM-5.08-成品         |

|           | pitch dimension |       |       | Nominal dimension |      |      |      |      | —<br>◇<br>○ |
|-----------|-----------------|-------|-------|-------------------|------|------|------|------|-------------|
|           | over            | over  | over  | over              | over | over | over | over |             |
| variable  | 0               | 6     | 10    | 0                 | 30   | 60   | 100  | 150  |             |
| range     | to              | to    | to    | to                | to   | to   | to   |      |             |
| Tolerance | ±0.1            | ±0.15 | ±0.25 | ±0.2              | ±0.3 | ±0.5 | ±0.7 | ±1.0 | 0.05/10     |