

REVISION		RECORD	
REV.	CONTENT	MOD.	DATE
①	初版发行		

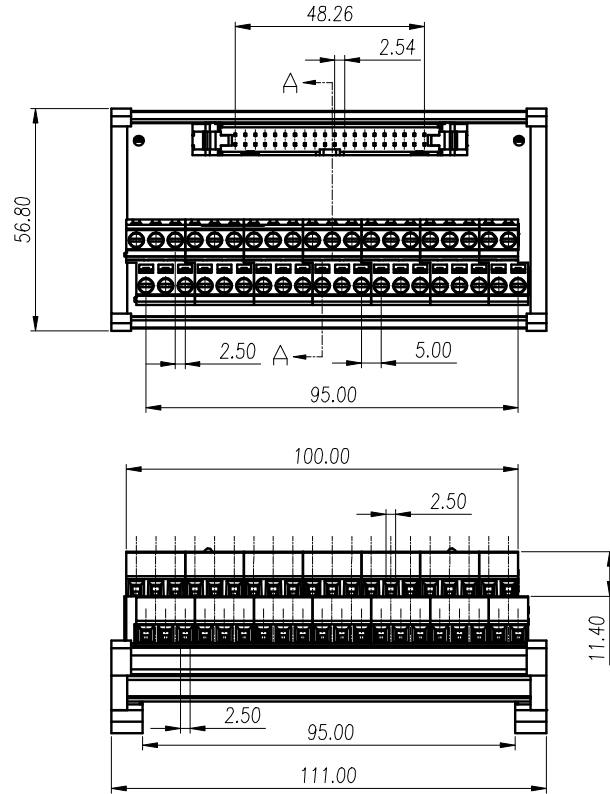

技术要求:
 间距: 5.0mm
 额定电压: 300V
 额定电流: 10A
 耐电压值: AC2500V/min
 绝缘阻抗: 5MΩ/DC500V
 使用条件: -40℃~+105℃
 适用线规: 26~14AWG
 螺丝扭矩: 0.4Nm

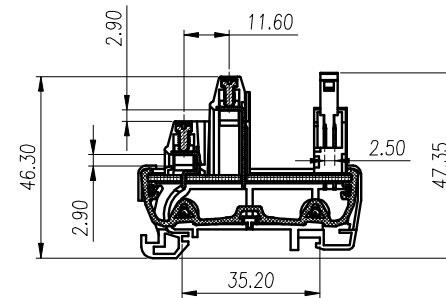

SECTION A-A

8	LG500BZL-5, 0-2*3-成品	LG500BZL-5, 0-2*3-140-00A	6	PA66	
7	LG500BZL-5, 0-2*2-成品	LG500BZL-5, 0-2*2-140-00A	1	PA66	
6	DC2-40P-牛角插座	6DC2A300407V	1		
5	MJC-F40端子横组基板	4017A0000AV	1		
4	M3, 0*12自攻螺丝	SQZ0A30A203V	4	铁	镀锌
3	JUM-52-主体	6JUMA400013V	1	PA66	绿色
2	JUM-52-右挡板	6JUMC400023V	1	PA66	绿色
1	JUM-52-左挡板	6JUMC400013V	1	PA66	绿色

NO.	NAME OF PART	NO. OF PART	QTY	MATERIAL
DES.	ZGC	DATE	2020/06/13	UNITS mm
CHK.		DATE		SIZE A4
APP.		DATE		SCALE 1:1

THIRD ANGLE PROJECTION SHEET		1 of 1	
DWG NO.	SP-2-GMJC/F40	REV:	V0
TITLE		MJC-F40 MJC-F40端子横组	

 上海有乐电气有限公司
Shanghai YouLe Electric CO.,LTD

	pitch dimension			Nominal dimension					— /
	over 0 to 6	over 6 to 10	over 10 to 24	over 0 to 30	over 30 to 60	over 60 to 100	over 100 to 150	over 150	
variable range									□ ○
Tolerance	±0.1	±0.15	±0.25	±0.2	±0.3	±0.5	±0.7	±1.0	0.05/10